

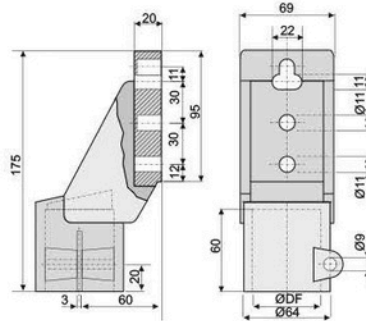

COMPONENTES

BASES - BASES

Soporte Lateral
Side Mounting Top
Bracket



| PIEZA | DESCRIP. | PESO | VENTA | COLOR | MATERIALES | ØD |
|-------------------|--------------------|----------------------|--------|-------|---|--------------------|
| 088 085 996 | SOPORTE LATERAL | 340g 330g 310g | Unidad | NEGRO | SOPORTE= PAFG TUERCA=AISI 304 TORNILLO=AISI 304 ARANDELA= AISI 304 | 38 48.3 50.8 |

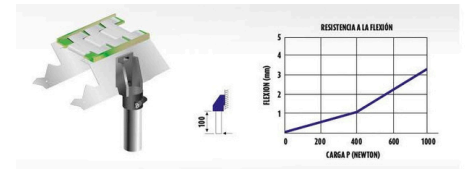

Soporte Caño Ø48.3
Lateral
4 Agujeros
Side Mounting Top
Bracket 48.3

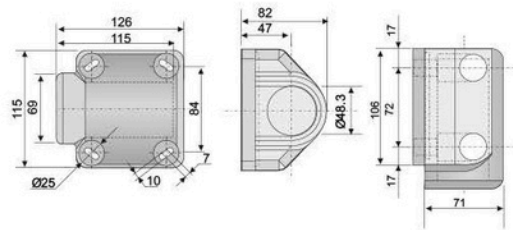

| PIEZA | DESCRIP. | PESO | VENTA | COLOR | MATERIALES |
|-------|----------------|------|--------|-------------------|---------------|
| 953 | D48,3 AGUJEROS | 101g | Unidad | NEGRO ALUMINIO | SOPORTE= PAFG |

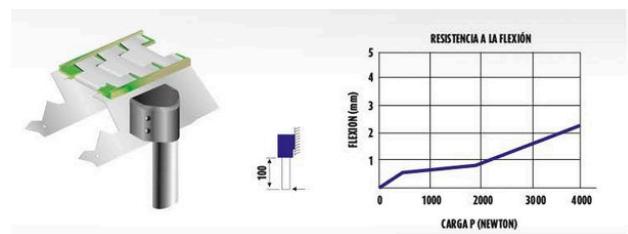

BASES - BASES

Soporte Caño Base Inferior 4 Agujeros 95x95

Support Head 95x95

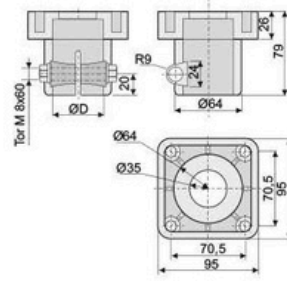

| PIEZA | DESCRIP. | PESO | VENTA | COLOR | MATERIALES |
|-------------------|--------------------------------------|------|--------|-------|---|
| 384 112 385 | BASE INFERIOR 4 AGUJEROS 95X95 | 307g | Unidad | NEGRO | SOPORTE= PAFG TUERCA= AISI 304 TORNILLO= AISI 304 ARANDELA= AISI 304 |

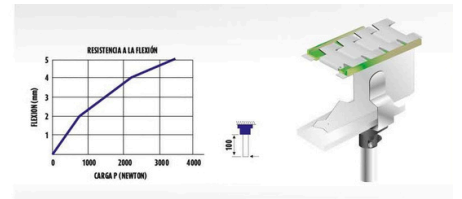

Soporte Caño Base Inferior 4 Agujeros 130x90

Support Head 130x90

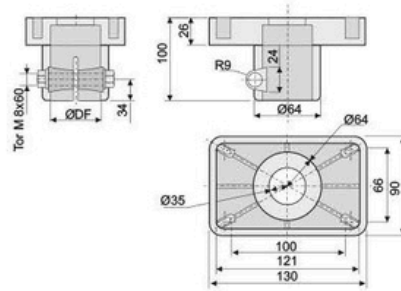

| PIEZA | DESCRIP. | PESO | VENTA | COLOR | MATERIALES |
|-------------------|------------------------------------|----------------------|--------|-------|---|
| 813 814 815 | BASE INFERIOR 4 AGUJEROS 130X90 | 468g 522g 522g | Unidad | NEGRO | SOPORTE= PAFG TUERCA= AISI 304 TORNILLO= AISI 304 ARANDELA= AISI 304 |



BASES - BASES

Abrazadora de Fijación Connecting Joint

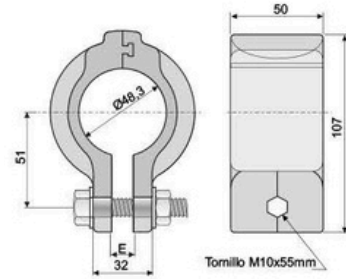

| PIEZA | DESCRIP. | PESO | VENTA | COLOR | MATERIALES |
|------------|------------|----------------|--------|-------|----------------------------------|
| 119 118 | ABRAZADERA | 278.4g 275g | Unidad | NEGRO | SOPORTE= PAFG ABRAZADERA=PAFG |



Unión Caño Connecting Joints

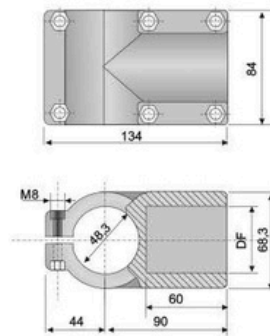

| PIEZA | DESCRIP. | PESO | VENTA | COLOR | MATERIALES |
|------------|------------|--------------|--------|-------|---|
| 801 802 | UNIÓN CAÑO | 400g 425g | Unidad | NEGRO | UNIÓN= PAFG TUERCA= AISI 304 TORNILLO= AISI 304 |



BASES - BASES

Base de Apoyo Bípode 180°

Bipods 180°

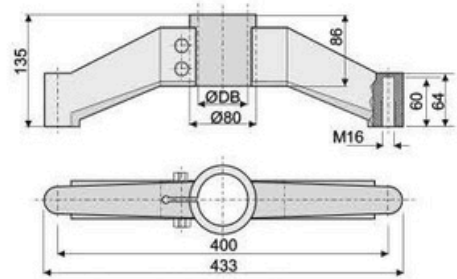

| PIEZA | DESCRIP. | PESO | VENTA | COLOR | MATERIALES | D Ø B |
|-------------------|------------------------|----------------------|--------|-------|---|----------------------|
| 089 444 090 | BASE BÍPODE 180° | 980g 970g 955g | Unidad | NEGRO | BASE DE APOYO=PAFG TUERCA= AISI 304 TORNILLO=AISI 304 INSERTO=NPB ARANDELA=AISI 304 | 48.3 50.8 60.3 |

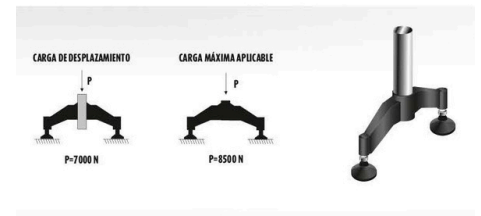

Base de Apoyo Bípode Salida Lateral 180°

Bipods 180° With Joint

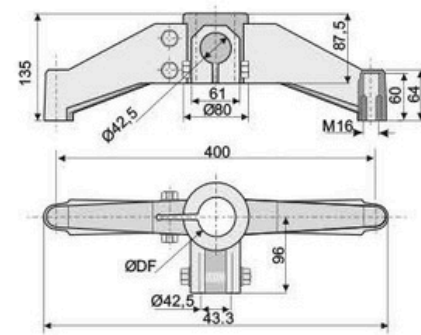

| PIEZA | DESCRIP. | PESO | VENTA | COLOR | MATERIALES | D Ø B |
|-------------------|---------------------------------------|-------------------------|--------|-------|---|----------------------|
| 415 445 416 | BASE BÍPODE SALIDA LATERAL 180° | 1100g 1090g 1075g | Unidad | NEGRO | BASE DE APOYO=PAFG TUERCA= AISI 304 TORNILLO=AISI 304 INSERTO=NPB ARANDELA=AISI 304 | 48.3 50.8 60.3 |

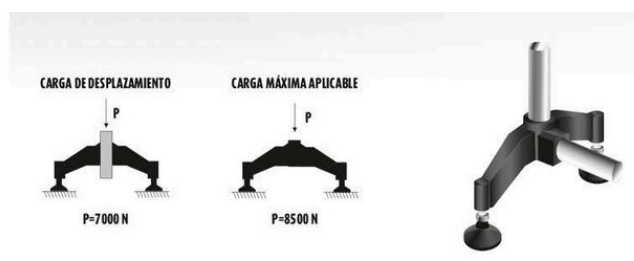

BASES - BASES

Base de Apoyo Bípode Salida Lateral 120° Bipods 120° With Joint

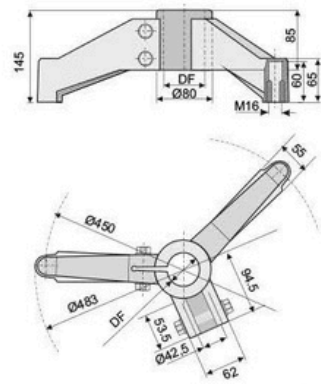

| PIEZA | DESCRIP. | PESO | VENTA | COLOR | MATERIALES | DF |
|-------|--------------|-------|--------|-------|---|------|
| 061 | BASE BÍPODE | 1100g | | | BASE DE APOYO=PAFG | 48.3 |
| 288 | SALIDA | 1090g | Unidad | NEGRO | TUERCA= AISI 304 | 50.8 |
| 087 | LATERAL 120° | 1075g | | | TORNILLO=AISI 304 INSERTO=NPB ARANDELA=AISI 304 | 60.3 |

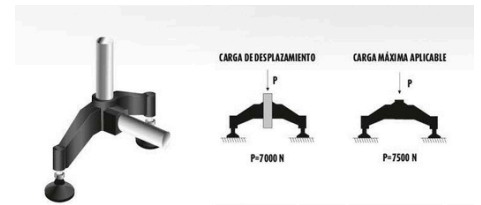

Base de Apoyo Trípode Tripods

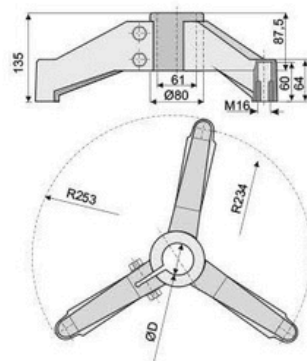

| PIEZA | DESCRIP. | PESO | VENTA | COLOR | MATERIALES | D Ø |
|-------|--------------|-------|--------|-------|---|------|
| 084 | BASE TRÍPODE | 1470g | | | BASE DE APOYO=PAFG | 48.3 |
| 137 | | 1455g | Unidad | NEGRO | TUERCA= AISI 304 | 50.8 |
| 138 | | 1433g | | | TORNILLO=AISI 304 INSERTO=NPB ARANDELA=AISI 304 | 60.3 |



BASES - BASES

Inserto Caño Redondo

Threated Tube End
Round Tubes

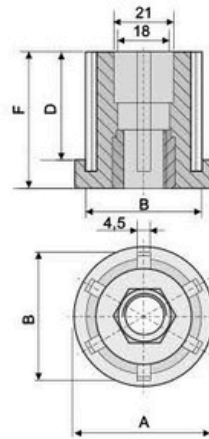

| PIEZA | DESCRIP. | PESO | VENTA | COLOR | MATERIALES | ØDF | A | B | D | F |
|-------|---------------|-------|--------|-------|--|-------------|------|------|------|----|
| 135 | INSERTO D48.3 | 70.5g | Unidad | NEGRO | INSERTO PLÁSTICO= PAFG INSERTO= NPB | M16 W5/8 | 48.3 | 45 | 38 | 48 |
| 392 | INSERTO D50.8 | 75g | | | | | 58.8 | 47.8 | 40.5 | 50 |
| 402 | INSERTO D50.8 | 75g | | | | | 58.8 | 47.8 | 40.5 | 50 |
| 930 | INSERTO D60.3 | 95g | | | | | 60.3 | 56.3 | 39 | 49 |
| 986 | INSERTO D60.3 | 95g | | | | | 60.3 | 56.3 | 39 | 49 |



Inserto Caño Cuadrado

Threated Tube End
Square Tubes

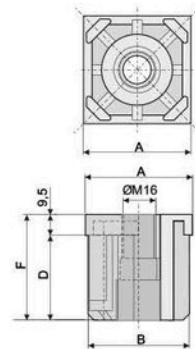
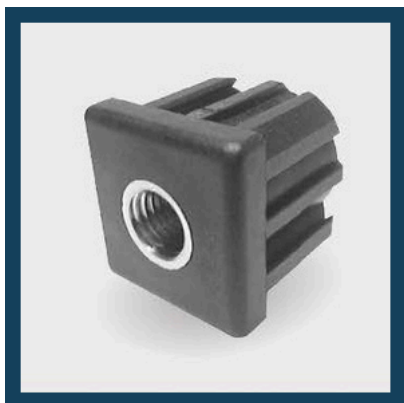

| PIEZA | DESCRIP. | PESO | VENTA | COLOR | MATERIALES | A | B | D | F |
|-------|---------------|------|--------|-------|--|----|------|----|----|
| 113 | 40X40 p1.5 mm | 65g | Unidad | NEGRO | INSERTO PLÁSTICO= PAFG INSERTO= NPB | 40 | 37.5 | 35 | 43 |
| 114 | 40x40 p2 mm | 63g | | | | 40 | 36.5 | 35 | 43 |
| 115 | 50x50 p1.5 mm | 92g | | | | 50 | 47.5 | 38 | 48 |
| 116 | 50x50 p2 mm | 90g | | | | 50 | 46.5 | 38 | 48 |



BASES - BASES

Base Lisa Ø60 Rotula M12

Articulated Foot Ø60 M12

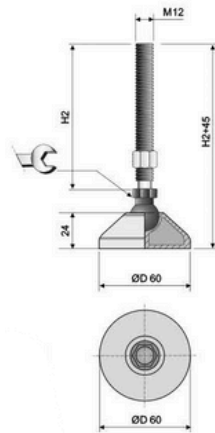

| PIEZA | DESCRIP. | PESO | VENTA | COLOR | MATERIALES | H2 | ROSCA | CARACT. TÉCNICAS |
|-------|----------|------|--------|-------|----------------------------------|-----|-------|--------------------------------|
| 1804 | AISI | 127g | Unidad | NEGRO | BASE=PA VÁSTAGO= VER TABLA | 60 | M12 | ÁNGULO DE OSCILACIÓN 15° |
| 1805 | | 181g | | | | 100 | | |
| 1868 | | 127g | | | | 60 | | |
| 1869 | | 181g | | | | 100 | | |
| 1806 | FEZN | 127g | Unidad | NEGRO | BASE=PA VÁSTAGO= VER TABLA | 60 | M12 | ÁNGULO DE OSCILACIÓN 15° |
| 1807 | | 181g | | | | 100 | | |
| 1866 | | 127g | | | | 60 | | |
| 1867 | | 181g | | | | 100 | | |



Base Lisa Ø60 con Rosca Metálica

Articulated Foot Ø60
With Metallic Spindle

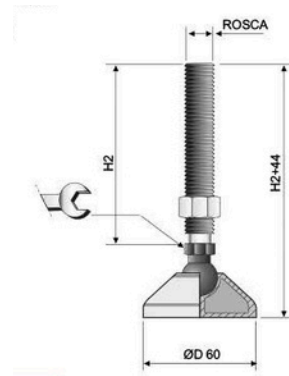

| PIEZA | DESCRIP. | PESO | VENTA | COLOR | MATERIALES | H2 | ROSCA | CARACT. TÉCNICAS |
|-------|----------|------|--------|-------|--|-----|-------|--------------------------------|
| 094 | AISI | 147g | Unidad | NEGRO | BASE=PA VÁSTAGO= VER TABLA TUERCA= VER TABLA | 60 | M16 | ÁNGULO DE OSCILACIÓN 15° |
| 095 | | 201g | | | | 100 | | |
| 096 | | 267g | | | | 150 | | |
| 286 | | 147g | | | | 60 | | |
| 387 | FENZ | 201g | Unidad | NEGRO | BASE=PA VÁSTAGO= VER TABLA TUERCA= VER TABLA | 100 | W5/8 | ÁNGULO DE OSCILACIÓN 15° |
| 388 | | 267g | | | | 150 | | |
| 389 | | 147g | | | | 60 | | |
| 890 | | 201g | | | | 100 | | |
| 391 | FENZ | 267g | Unidad | NEGRO | BASE=PA VÁSTAGO= VER TABLA TUERCA= VER TABLA | 150 | M16 | ÁNGULO DE OSCILACIÓN 15° |
| 612 | | 147g | | | | 60 | | |
| 613 | | 201g | | | | 100 | | |
| 614 | | 267g | | | | 150 | | |

BASES - BASES

Base Lisa Ø60 Rotula con Rosca Plástica
Articulated Foot Ø60
With Plastic Spindle

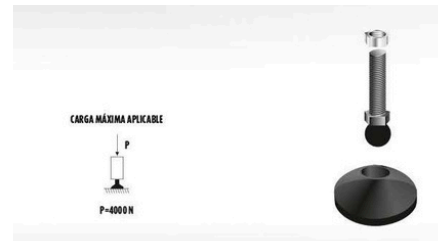
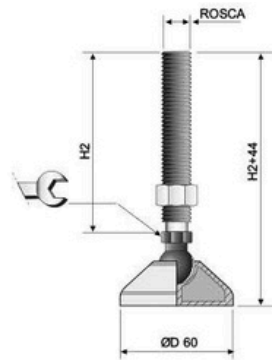

| PIEZA | DESCRIP. | PESO | VENTA | COLOR | MATERIALES | H2 | ROSCA | CARACT. TÉCNICAS |
|------------|---------------------|------|--------|-------|--|----|------------|--------------------------|
| 976 981 | D 60 ROSCA PLÁSTICA | 137g | Unidad | NEGRO | BASE=PA VÁSTAGO= PA FEZN TUERCA= FEZN | 60 | M16 M14 | ÁNGULO DE OSCILACIÓN 15° |

Suplemento Goma Ø60
Antivibration Ø60

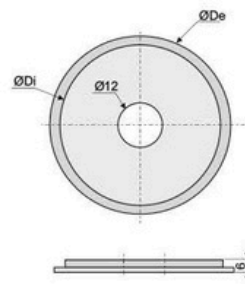

| PIEZA | DESCRIP. | PESO | VENTA | COLOR | MATERIALES | ØDi | ØDe | CARACT. TÉCNICAS |
|-------|----------------|------|--------|-------|--------------------|-----|-----|--|
| 417 | ANTIVIBRATORIO | 18g | Unidad | NEGRO | SUPLEMENTO= RUBBER | 53 | 60 | FIJACIÓN: POR ENCASTRE DUREZA: 70 SHORE |

BASES - BASES

Base Lisa Ø80 Rotula M12

Articulated Foot Ø80 M12

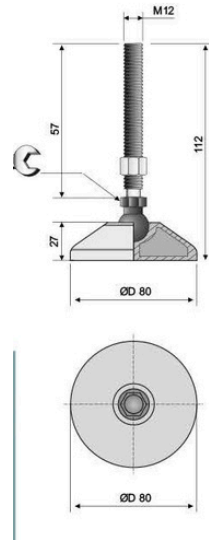

| PIEZA | DESCRIP. | PESO | VENTA | COLOR | MATERIALES | H2 | ROSCA | CARACT. TÉCNICAS |
|-------|----------|------|--------|-------|--|-----|-------|--------------------------------|
| 1812 | AISI | 137g | Unidad | NEGRO | BASE=PA VÁSTAGO= VER TABLA TUERCA= VER TABLA | 60 | M12 | ÁNGULO DE OSCILACIÓN 15° |
| 1813 | | 191g | | | | 100 | | |
| 1872 | | 137g | | | | 60 | | |
| 1873 | | 191g | | | | 100 | | |
| 1814 | | 137g | | | | 60 | | |
| 1815 | FEZN | 191g | Unidad | NEGRO | BASE=PA VÁSTAGO= VER TABLA TUERCA= VER TABLA | 100 | M12 | |
| 1870 | | 137g | | | | 60 | | |
| 1871 | | 191g | | | | 100 | | |

Base Lisa Ø80 con Rosca Metálica

Articulated Foot Ø80
With Metallic Sprindle

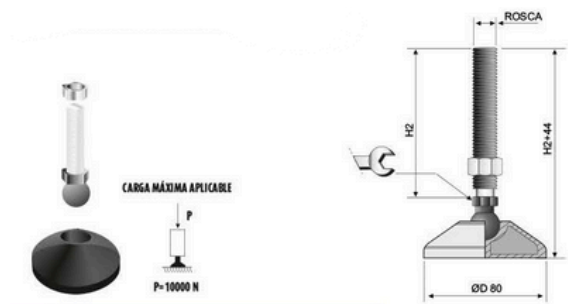

| PIEZA | DESCRIP. | PESO | VENTA | COLOR | MATERIALES | H2 | ROSCA | CARACT. TÉCNICAS |
|-------|----------|------|--------|-------|--|-----|-------|-----------------------------|
| 639 | AISI | 176g | Unidad | NEGRO | BASE=PA VÁSTAGO= VER TABLA TUERCA= VER TABLA | 60 | M16 | ÁNGULO DE OSCILACIÓN 15° |
| 640 | | 220g | | | | 100 | | |
| 641 | | 279g | | | | 150 | | |
| 645 | FEZN | 176g | Unidad | NEGRO | BASE=PA VÁSTAGO= VER TABLA TUERCA= VER TABLA | 60 | M16 | ÁNGULO DE OSCILACIÓN 15° |
| 646 | | 220g | | | | 100 | | |
| 647 | | 279g | | | | 150 | | |
| 651 | AISI | 176g | Unidad | NEGRO | BASE=PA VÁSTAGO= VER TABLA TUERCA= VER TABLA | 60 | W5/8 | ÁNGULO DE OSCILACIÓN 15° |
| 652 | | 220g | | | | 100 | | |
| 653 | | 279g | | | | 150 | | |
| 657 | FEZN | 176g | Unidad | NEGRO | BASE=PA VÁSTAGO= VER TABLA TUERCA= VER TABLA | 60 | W5/8 | ÁNGULO DE OSCILACIÓN 15° |
| 658 | | 220g | | | | 100 | | |
| 659 | | 279g | | | | 150 | | |

BASES - BASES

Base Lisa Ø80 con Rosca Plástica

Articulated Foot Ø80
With Plastic Spindle

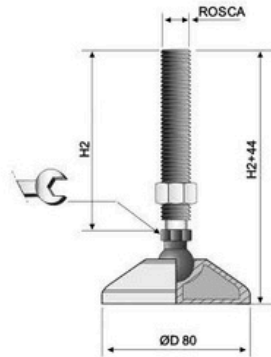

| PIEZA | DESCRIP. | PESO | VENTA | COLOR | MATERIALES | H2 | ROSCA | CARACT. TÉCNICAS |
|------------|---------------------------|------|--------|-------|---|----|------------|--------------------------------|
| 978 983 | D 80 ROSCA PLÁSTICA | 158g | Unidad | NEGRO | BASE=PA VÁSTAGO= PA FEZN TUERCA= FENZ | 60 | M16 M14 | ÁNGULO DE OSCILACIÓN 15° |

Base Anclar Ø80 Rotula M12

Articulated Foot Ø80
With Hole M12

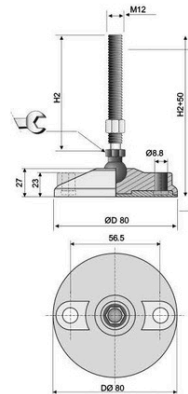

| PIEZA | DESCRIP. | PESO | VENTA | COLOR | MATERIALES | H2 | ROSCA | CARACT. TÉCNICAS |
|--|--------------------------|--|--------|-------|--|--|------------------------------------|-----------------------------|
| 1808 1809 1876 1877 1810 1811 1874 1875 | AISI FEZN | 137g 191g 137g 191g 137g 191g 137g 191g | Unidad | NEGRO | BASE=PA VÁSTAGO= VER TABLA TUERCA= VER TABLA | 60 100 60 100 60 100 60 100 | M12 W1/2 M12 W1/2 | ÁNGULO DE OSCILACIÓN 15° |

BASES - BASES

Base de Anclar Ø80 con Rosca Metálica

Articulated Foot Ø80
With Hole Metallic
Splindle

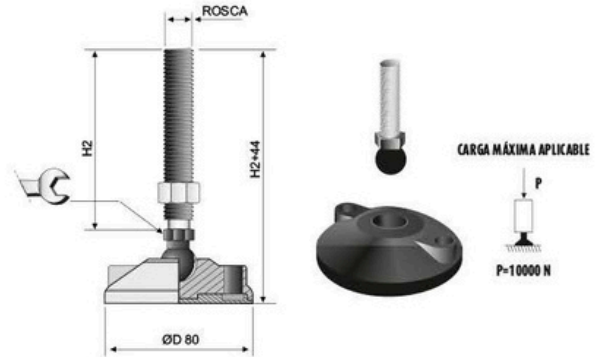

| PIEZA | DESCRIP. | PESO | VENTA | COLOR | MATERIALES | H2 | ROSCA | CARACT. TÉCNICAS |
|-------|----------|------|--------|-------|--|-----|-------|--------------------------------|
| 615 | | 176g | | | | 60 | | |
| 616 | AISI | 223g | | | | 100 | | |
| 617 | | 283g | | | | 150 | | |
| 621 | | 176g | | | | 60 | M16 | |
| 622 | FEZN | 223g | | | | 100 | | |
| 623 | | 283g | | | | 150 | | |
| 627 | | 176g | Unidad | NEGRO | BASE=PA VÁSTAGO=VER TABLA TUERCA= VER TABLA | 60 | | ÁNGULO DE OSCILACIÓN 15° |
| 628 | AISI | 223g | | | | 100 | | |
| 629 | | 283g | | | | 150 | W5/8 | |
| 633 | | 176g | | | | 60 | | |
| 634 | FEZN | 223g | | | | 100 | | |
| 635 | | 283g | | | | 150 | | |

Base Anclar Ø80 con Rosca Plástica

Articulated Foot Ø80
With Hole And Plastic
Splindle

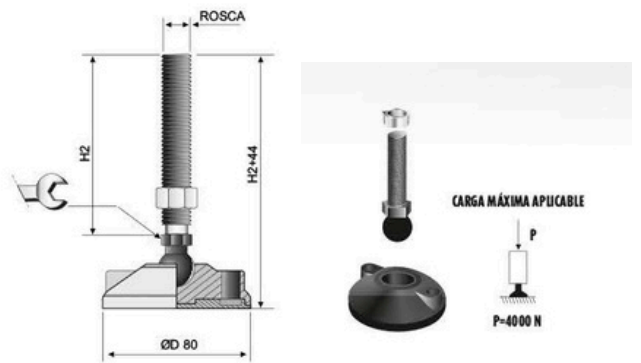

| PIEZA | DESCRIP. | PESO | VENTA | COLOR | MATERIALES | H2 | ROSCA | CARACT. TÉCNICAS |
|-------|--------------------|------|--------|-------|--|----|------------|-----------------------------|
| 977 | D 80 ANCLAR | | | | | | | |
| 882 | RÓTULA PLÁSTICA | 150g | Unidad | NEGRO | BASE=PA VÁSTAGO= VER TABLA TUERCA= VER TABLA | 60 | M16 M14 | ÁNGULO DE OSCILACIÓN 15° |

BASES - BASES

Suplementos Goma

Ø80

Antivibration Ø80

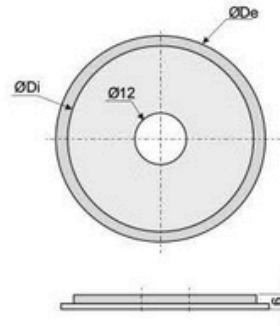

| PIEZA | DESCRIP. | PESO | VENTA | COLOR | MATERIALES | ØDi | ØDe | CARACT. TÉCNICAS |
|-------|----------------|-------|--------|-------|--------------------|-----|-----|--|
| 675 | ANTIVIBRATORIO | 34.5g | Unidad | NEGRO | SUPLEMENTO= RUBBER | 72 | 80 | FIJACIÓN POR ENCASTRE DUREZA: 70 SHORE |

Base Lisa Ø100 Rotula M12

Articulated Foot Ø100 M12

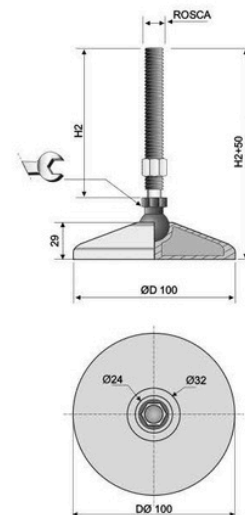

| PIEZA | DESCRIP. | PESO | VENTA | COLOR | MATERIALES | H2 | ROSCA | CARACT. TÉCNICAS |
|--|------------------------------|--|--------|-------|--|--|--|--------------------------|
| 1820 1821 1880 1881 1882 1823 1878 1878 1879 | AISI FEZN | 147g 201g 147g 201g 147g 201g 147g 201g 201g | Unidad | NEGRO | BASE=PA VÁSTAGO= VER TABLA TUERCA= VER TABLA | 60 100 60 100 60 100 60 100 | M12 M1/2 M12 M1/2 | ÁNGULO DE OSCILACIÓN 15° |

BASES - BASES

Suplementos Goma

Ø80

Antivibration Ø80

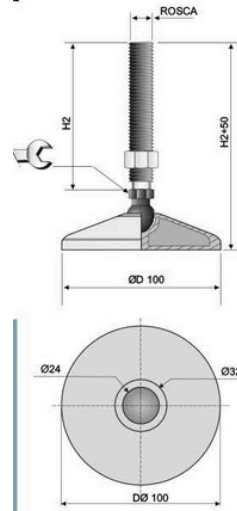

| PIEZA | DESCRIP. | PESO | VENTA | COLOR | MATERIALES | H2 | ROSCA | CARACT. TÉCNICAS |
|-------|----------|------|--------|-------|--|-----|-------|---|
| 091 | AISI | 182g | Unidad | NEGRO | BASE=PA VÁSTAGO= VER TABLA TUERCA= VER TABLA | 60 | M16 | FIJACIÓN POR ENCASTRE DUREZA: 70 SHORE |
| 092 | | 237g | | | | 100 | | |
| 093 | | 303g | | | | 150 | | |
| 395 | | 183g | | | | 60 | | |
| 396 | | 237g | | | | 100 | | |
| 397 | 303g | 150 | W5/8 | | | | | |
| 398 | 182g | 60 | | | | | | |
| 899 | 237g | 100 | | | | | | |
| 400 | FEZN | 303g | | 150 | M16 | | | |
| 672 | | 183g | | 60 | | | | |
| 673 | | 237g | 100 | | | | | |
| 674 | | 303g | 150 | | | | | |

Base Lisa Ø100 Rotula

M12

Articulated Foot Ø100

M12

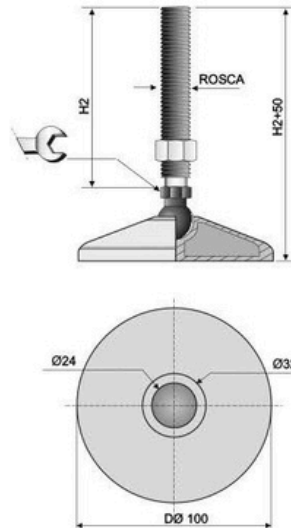
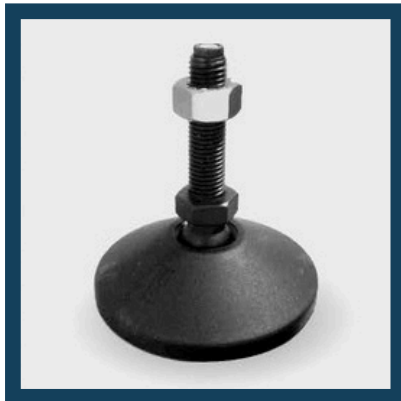

| PIEZA | DESCRIP. | PESO | VENTA | COLOR | MATERIALES | H2 | ROSCA | CARACT. TÉCNICAS |
|-------|-------------------------|------|--------|-------|---|----|------------|-----------------------------|
| 980 | D 100 ROSCA PLÁSTICA | 175g | Unidad | NEGRO | BASE=PA VÁSTAGO= PA FEZN TUERCA= FEZN | 60 | M16 M14 | ÁNGULO DE OSCILACIÓN 15° |
| 985 | | | | | | | | |

BASES - BASES

**Base de Anclar Ø100
Rotula M12**
Articulated Foot Ø100
With Hole M12

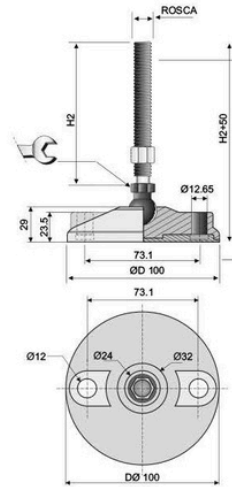

| PIEZA | DESCRIP. | PESO | VENTA | COLOR | MATERIALES | H2 | ROSCA | CARACT. TÉCNICAS |
|--------------|----------|--------------|--------|-------|--|----|-------|-----------------------------|
| 1816 1817 | AISI | 147g 201g | Unidad | NEGRO | BASE=PA VÁSTAGO= VER TABLA TUERCA= VER TABLA | 60 | M12 | ÁNGULO DE OSCILACIÓN 15° |
| 1884 1885 | | 147g 201g | | | | 60 | | |
| 1818 1819 | | 147g 201g | | | | 60 | | |
| 1882 1883 | | 147g 201g | | | | 60 | | |

**Base para Anclar Ø100
con Rosca Metálica**
Articulated Foot Ø100
With Hole And Metalic
Sprindle

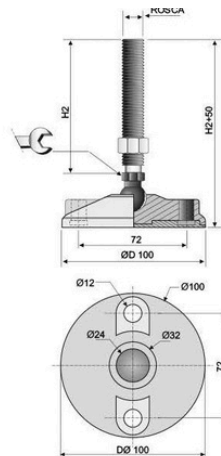

| PIEZA | DESCRIP. | PESO | VENTA | COLOR | MATERIALES | H2 | ROSCA | CARACT. TÉCNICAS |
|--|----------|----------------------|--------|-------|---|-----|-------|-----------------------------|
| 086 404 405 406 407 408 409 410 411 666 667 668 | AISI | 188g 242g 308g | Unidad | NEGRO | BASE=PA VÁSTAGO= PA FEZN TUERCA= FEZN | 60 | M16 | ÁNGULO DE OSCILACIÓN 15° |
| 188g 242g | | 60 | | | | | | |
| 308g | | 60 | | | | | | |
| 409 410 411 666 667 668 | FEZN | 188g 242g 308g | | | | 100 | W5/8 | |
| 188g 242g 308g | | 100 | | | | | | |

BASES - BASES

Base Lisa Ø100 con Rosca Metálica
Articulated Foot Ø100
With Metallic Spindle

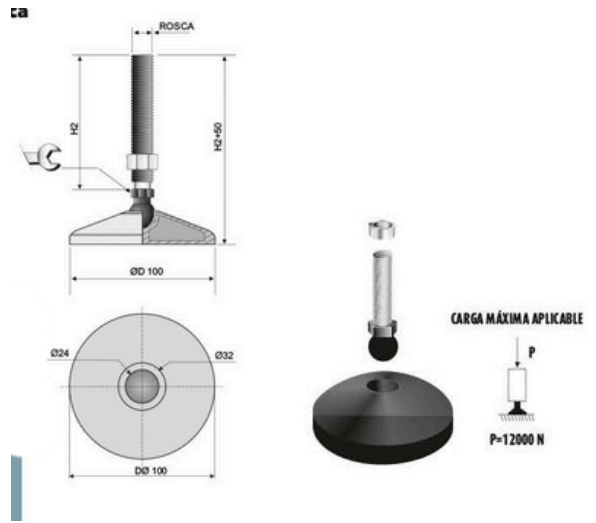

| PIEZA | DESCRIP. | PESO | VENTA | COLOR | MATERIALES | H2 | ROSCA | CARACT. TÉCNICAS |
|-------|----------|------|--------|-------|--|-----|-------|--------------------------|
| 091 | AISI | 182g | Unidad | NEGRO | BASE=PA VÁSTAGO= VER TABLA TUERCA= VER TABLA | 60 | M16 | ÁNGULO DE OSCILACIÓN 15° |
| 092 | | 237g | | | | 100 | | |
| 093 | | 303g | | | | 150 | | |
| 395 | | 183g | | | | 60 | | |
| 396 | | 237g | | | | 100 | | |
| 397 | 303g | 150 | W5/8 | | | | | |
| 398 | 182g | 60 | | | | | | |
| 399 | 237g | 100 | | | | | | |
| 400 | FEZN | 303g | | 150 | | | | |
| 672 | 183g | 60 | | W5/8 | | | | |
| 673 | 237g | 100 | | | | | | |
| 674 | 303g | 150 | | | | | | |

Base para Anclar Ø100 con Rosca Plástica
Articulated Foot Ø100
With Hole And Plastic Sprindle

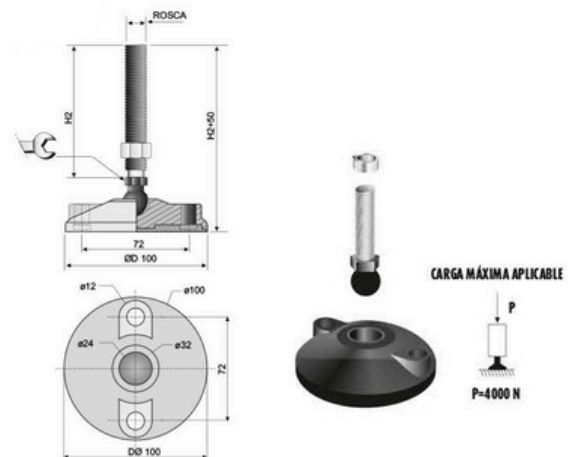

| PIEZA | DESCRIP. | PESO | VENTA | COLOR | MATERIALES | H2 | ROSCA | CARACT. TÉCNICAS |
|-------|----------------------|------|--------|-------|---|----|------------|--------------------------|
| 979 | D 100 ROSCA PLÁSTICA | 175g | Unidad | NEGRO | BASE=PA VÁSTAGO= PA FEZN TUERCA= FEZN | 60 | M16 M14 | ÁNGULO DE OSCILACIÓN 15° |
| 984 | | | | | | | | |

BASES - BASES

Suplemento Goma Ø100
Antivibration Ø100

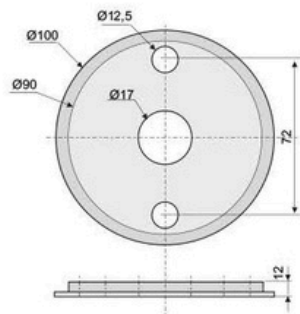

| PIEZA | DESCRIP. | PESO | VENTA | COLOR | MATERIALES | CARACT. TÉCNICAS |
|-------|----------------|------|--------|-------|--------------------|--|
| 418 | ANTIVIBRATORIO | 56g | Unidad | NEGRO | SUPLEMENTO= RUBBER | FIJACIÓN POR ENCASTRE DUREZA: 70 SHORE |

EJEMPLO DE APLICACIÓN:



BASES - BASES

Base Articulada Ø100 mm M20 Oscilante
Articulated Foot Ø100 M20

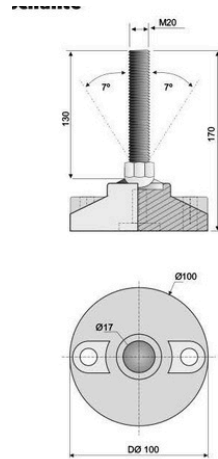

| PIEZA | DESCRIP. | PESO | VENTA | COLOR | MATERIALES | H2 | ROSCA | CARACT. TÉCNICAS |
|-------------|--------------------------|------|--------|-------|--|--|-------|-------------------------|
| 905 1088 | D 100 AISI D 100 FEZN | 525g | Unidad | NEGRO | BASE=PA VÁSTAGO= VER TABLA TUERCA= VER TABLA | 60 100 150 60 100 150 60 100 150 | M20 | ÁNGULO DE OSCILACIÓN 7° |

Base Ø100 M30 para Anclar Oscilante
Foot Ø100 M30

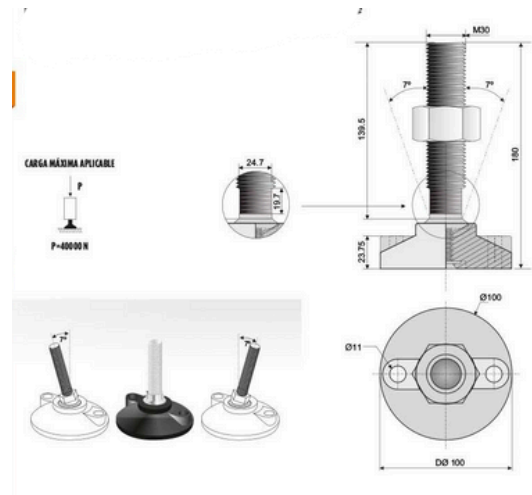

| PIEZA | DESCRIP. | PESO | VENTA | COLOR | MATERIALES | ROSCA | CARACT. TÉCNICAS |
|--------------|--------------------------|------|--------|-------------------|---|-------|-------------------------|
| 1350 1886 | D 100 AISI D 100 FEZN | 825g | Unidad | NEGRO ALUMINIO | BASE=PA VÁSTAGO= PA FEZN TUERCA= FEZN | M30 | ÁNGULO DE OSCILACIÓN 7° |

BASES - BASES

Base Ø124 M20

Foot Ø124 M20

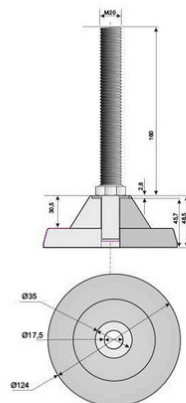

| PIEZA | DESCRIP. | PESO | VENTA | COLOR | MATERIALES | ROSCA |
|-------------|--------------------------|------|--------|-------|--|-------|
| 906 1089 | D 124 AISI D 124 FEZN | 703g | Unidad | NEGRO | BASE=PA VÁSTAGO= VER TABLA TUERCA= VER TABLA | M20 |

Base Línea Ø132 M20 con Vástago H200

Foot Ø132 M20 With Pin
H200

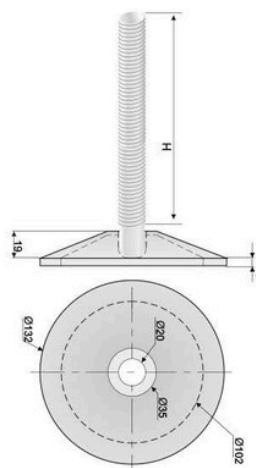

| PIEZA | DESCRIP. | PESO | VENTA | COLOR | MATERIALES | ROSCA | H2 |
|------------|-------------------------|------|--------|-------|---|-------|-----|
| 907 870 | BASE INOX. BASE FEZN | 703g | Unidad | NEGRO | BASE=PA VÁSTAGO= PA FEZN TUERCA= FEZN | M20 | 200 |

BASES - BASES

Base Rosca Ø128 M24 con Vástago H 200
Foot Ø128 M24 With Threaded Pin H20

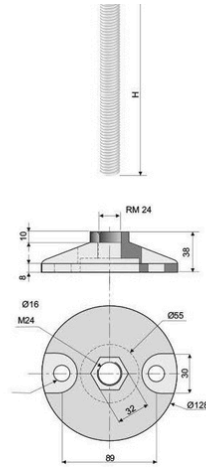

| PIEZA | DESCRIP. | PESO | VENTA | COLOR | MATERIALES | ROSCA | H2 |
|------------|-------------------------|------|--------|-------|---|-------|-----|
| 867 904 | BASE INOX. BASE FEZN | 703g | Unidad | NEGRO | BASE=PA VÁSTAGO= PA FEZN TUERCA= FEZN | M24 | 200 |

Base Ø98 para 2000 kg.
Foot Ø198

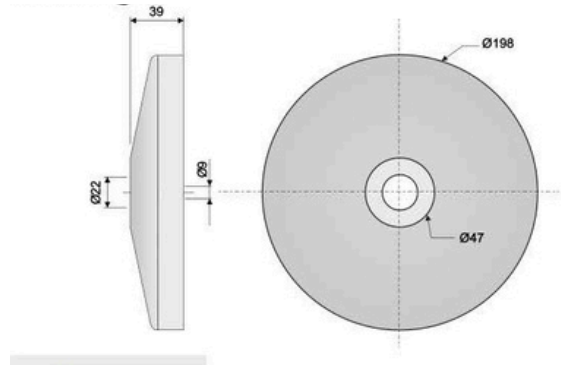

| PIEZA | DESCRIP. | PESO | VENTA | COLOR | MATERIALES |
|-------|---------------------|------|--------|-------|------------|
| 054 | D 198 PARA 2000 kg. | 443g | Unidad | NEGRO | BASE=PA |





DONDE ESTAMOS

**MONTEVIDEO 561
GUAYMALLÉN (5519).
MENDOZA. ARGENTINA**

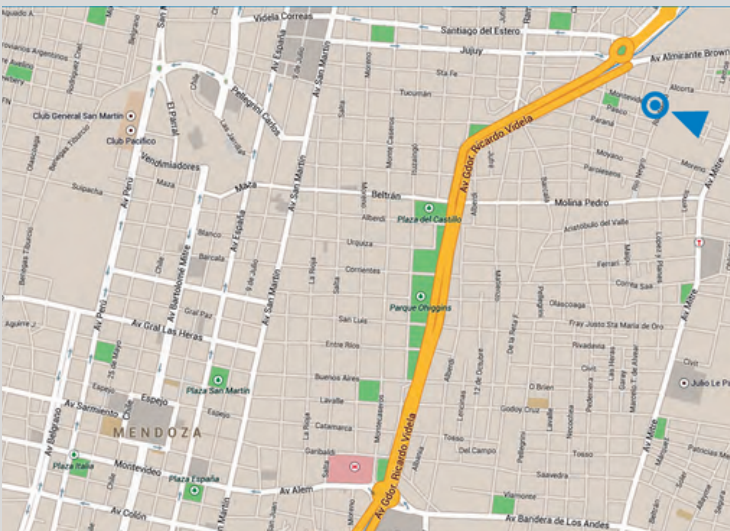

CONTÁCTANOS

+54 9 261 3878497

www.surtecnica.ar

infocomercial@surtecnica.com

[surtecnica](https://www.instagram.com/surtecnica)

